

## PSM12 Point Source Monitor

The PSM12 addresses a need for an extremely powerful yet compact Floor Monitor with the qualities of the ground-breaking PSM18 in a much smaller package. It features a custom designed 4" voice coil 12" driver for maximum power at low frequencies and a 1.4" compression driver for high frequencies. Funktion One's unique driver technology allows the compression driver crossover point to be nearly an octave higher than is typical, resulting in an extremely present but smooth sound particularly under pressure. The 70° high frequency conical waveguide is concentric with the 12" driver giving a point-source arrangement which is optimum for even coverage and minimising feedback. The monitor is switchable between passive and active operation and is supplied with a 35mm integral stand mount. Funktion One's holistic driver, enclosure and waveguide design make this product an outstanding monitor.



### Features:

- Small yet powerful
- Neodymium magnets
- Sturdy construction
- Point source driver arrangement
- Integral 35mm pole mount
- Switchable passive network

Driver	Operating Band*	Sensitivity (1W at 1m)	Power (rms**)	Nominal Impedance
12"	30 - 2k5Hz	101dB	400W	8Ω
1.4"	2k5Hz - up	109dB	75W	16Ω

\*Please check website for latest crossover settings

\*\*AES rated

Frequency Response  $\pm 3\text{dB}$ :

65Hz - 17kHz

Weight:

23kg (50lbs)

Nominal Dispersion:

70° Conical

Connectors:

2 x Speakon NL4

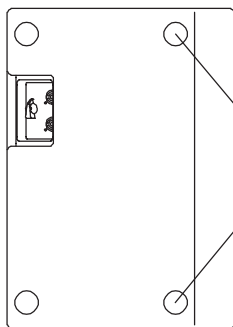

Stabilising feet

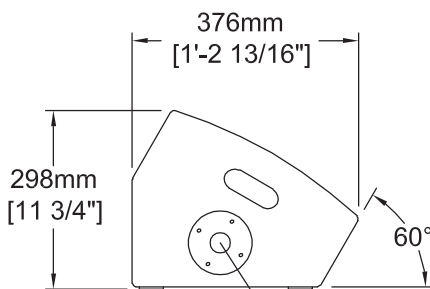

298mm  
[11 3/4"]

35mm Top Hat

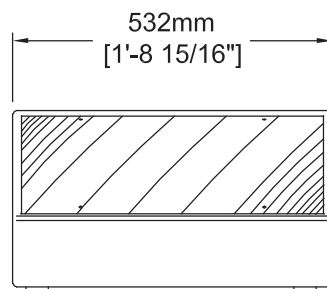

532mm  
[1'-8 15/16"]

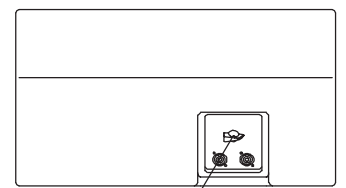
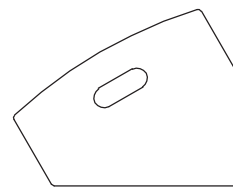

Passive/Active  
Switch

